

6/29/19

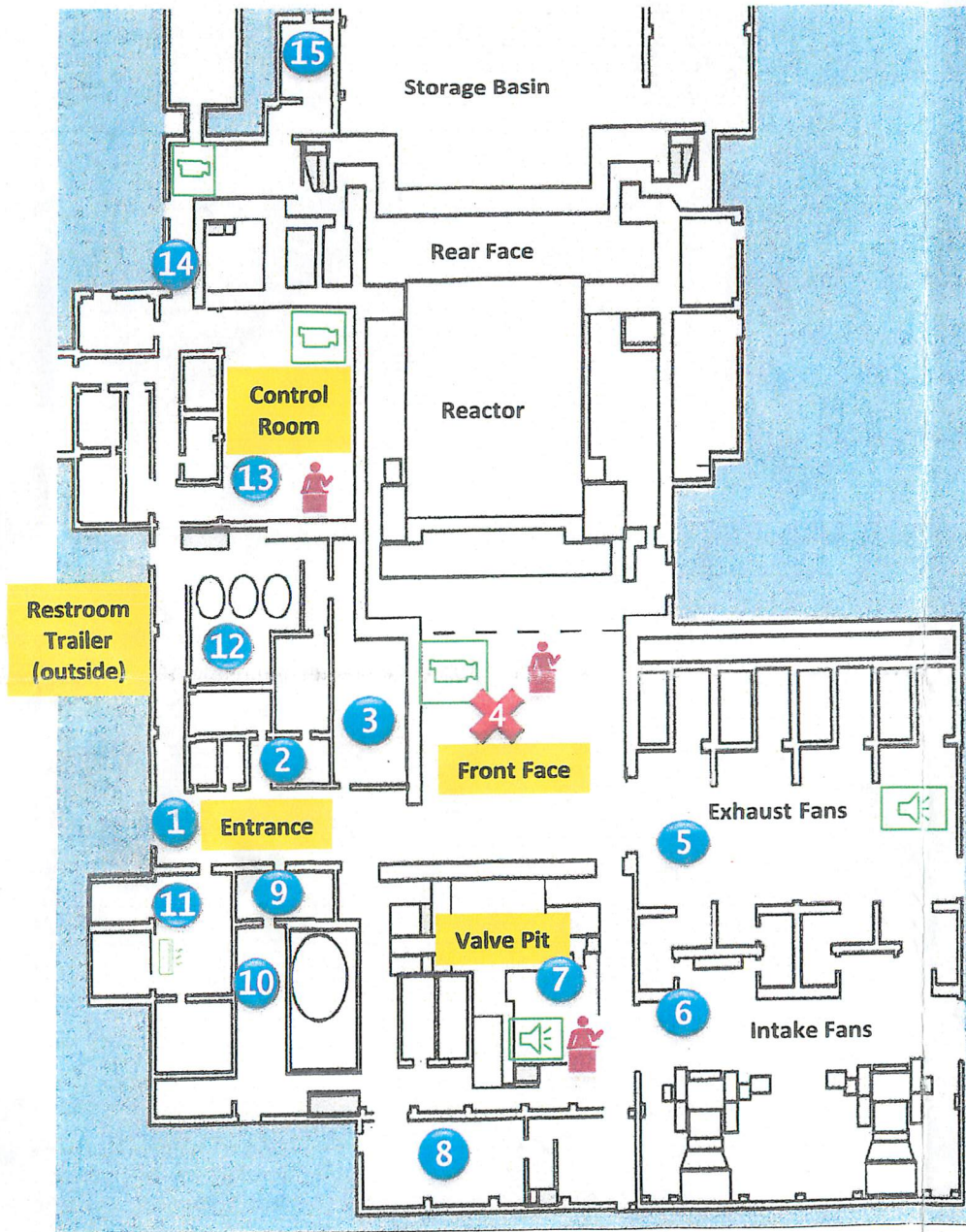

- 1 Entrance - Double glass doors. **Water is available in ice chest.**
- 2 Instrument Repair Room - Office setting and repair equipment from the Manhattan Project era.
- 3 Electrical Equipment Room - Various electric power distribution panels used to operate the reactor; seismograph shutdown system.
- ~~4~~ Front Face - Reactor and tools/equipment. Videos available on the history and construction of the reactor. **30-minute presentation upon arriving at reactor.**
- 5 Exhaust Fan Hallway - Four large exhaust fans vented air through a stack; two are steam operated and two are electrically operated. Mobot display. **Audio vignette available.**
- 6 Intake Fan Hallway - Large intake fans bring in fresh air. Also on display are old tools and equipment that were used at Hanford.
- 7 Valve Pit Room - Treated water entered the building here and then was pumped through the process tubes. **Audio vignette available. 10-minute presentation.**
- 8 Water Laboratory - Various displays and electronic equipment from the Manhattan Project era.
- 9 Exhibit Room - Typical personal protection equipment (PPE) of the Manhattan Project era.
- 10 Radiological Safety Display - Radiological Safety signs, Radiation and Contamination detection instruments, and Special Work Permit clothing. These items and equipment were used during the early years of B Reactor operations from 1943 through 1968.
- 11 Visitor Break Room - Miscellaneous photographs and advertisements from Manhattan Project era. **Contains wall A/C unit.**
- 12 Accumulator Room - Back-up system for inserting Horizontal Control Rods (HCRs) in the event of a power failure.
- 13 Control Room - Videos available detailing how operators monitored and regulated the reactor when in operation. Supervisor's office and an office used by Enrico Fermi with period furnishings located at rear of Control Room. **10-minute presentation.**
- 14 Fuel Discharge and Processing - Videos available detailing how fuel was discharged and then processed to recover plutonium in the 200 Areas.
- 15 Fuel Storage Basin Viewing Room - Irradiated fuel is stored in these basins prior to being shipped to the 200 Area for processing.

HANFORD, WA